

# **MAINTENANCE-FREE RECHARGEABLE BATTERY** **FRONT TERMINAL LONG LIFE**



## **General Features**

- Absorbent Glass Mat (AGM) technology for efficient gas recombination of up to 99% and freedom from electrolyte maintenance or water adding.
- Not restricted for air transport-complies with IATA/ICAO Special Provision A67.
- UL-recognized component.
- Can be mounted in any orientation.
- Computer designed lead, calcium tin alloy grid for high power density.
- Long service life, float or cyclic applications.
- Maintenance-free operation.
- Low self discharge.

## **Dimensions and Weight**

Length(mm / inch)	560/21.73
Width(mm / inch)	125/4.92
Height(mm / inch)	316/12.44
Total Height(mm / inch)	316/12.44
Approx. Weight(Kg / lbs)	52/114.40
Standard Terminal	I

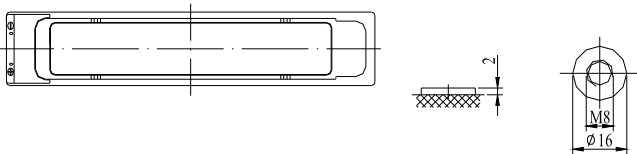
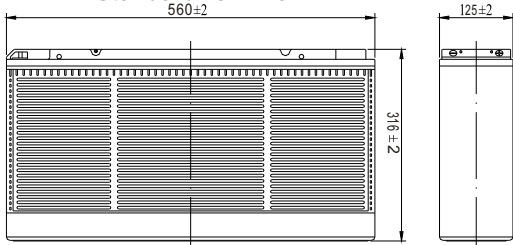

## **Specification**

Nominal Voltage	12V
Number of cell	6
Design Life	12 years
Nominal Capacity 77°F(25°C)	
20 hour rate (7.75A, 10.8V)	155Ah
10 hour rate (15.0A, 10.8V)	150Ah
5 hour rate (27.10A, 10.5V)	135.58Ah
1 hour rate (94.61A, 9.6V)	94.61Ah
Internal Resistance	
Fully Charged battery 77°F(25°C)	4mOhms
Self-Discharge	
3% of capacity declined per month at 20°C(average)	
Operating Temperature Range	
Discharge	-20~60°C
Charge	-10~60°C
Storage	-20~60°C
Max. Discharge Current 77°F(25°C)	980A(5s)
Charge Methods: Constant Voltage Charge 77°F(25°C)	
Cycle use	14.4-14.7V
Maximum charging current	45.0A
Temperature compensation	-30mV/°C
Standby use	13.6-13.8V
Temperature compensation	-20mV/°C

## **Discharge Constant Current (Amperes at 77°F25°C)**

End Point Volts/Cell	10min	15min	30min	45min	1h	3h	5h	10h
1.60V	317	267	153	107	94.6	37.3	29.2	15.5
1.65V	299	249	148	104	93.5	36.8	28.3	15.4
1.70V	277	231	144	100	90.4	36.1	27.9	15.3
1.75V	256	217	140	98.3	89.2	34.5	27.6	15.2
1.80V	235	203	135	94.5	88.1	33.1	27.1	15.0

## **Discharge Constant Power (Watts at 77°F25°C)**

End Point Volts/Cell	10min	15min	30min	45min	1h	2h	3h	5h
1.60V	503	413	273	204	171	99.1	75.2	49.9
1.65V	469	393	265	200	168	97.9	74.4	49.1
1.70V	452	375	260	196	165	96.3	73.2	48.5
1.75V	424	345	256	192	161	93.7	70.9	48.3
1.80V	396	308	252	188	159	91.6	69.2	48.0

**Discharge characteristic (25°C)**

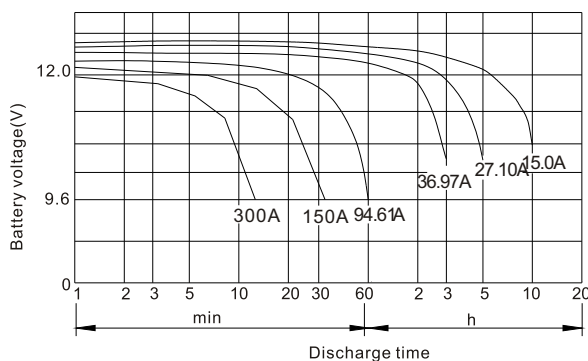

**Charge characteristic curve**

Constant voltage charge characteristic  
(0.25CA, 25°C)

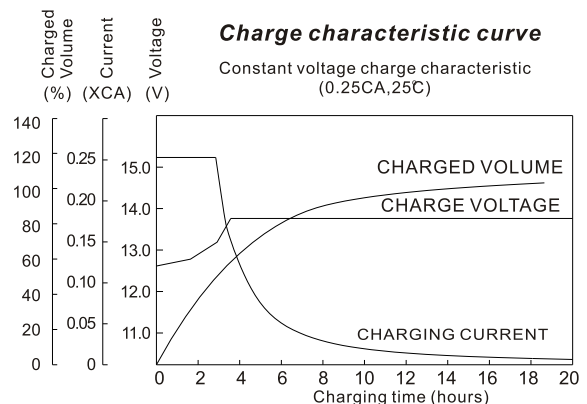

# **MAINTENANCE-FREE RECHARGEABLE BATTERY** **FRONT TERMINAL LONG LIFE**

